

17,066



Farmers Electric Cooperative

301 N. Hillcrest
Sulphur Springs, TX 75482

2000 I-30 E
Greenville, TX 75402

FILED FOR RECORD
at 1:30 o'clock P M

OCT 12 2021

BECKY LANDRUM
County Clerk, Hunt County, Tex.

By 108 W. Marble
Wylie, TX 75098

Thursday, October 7, 2021

Office of County Commissioners
PO BOX 1097
Greenville TX 75403

Farmers Electric Cooperative Member: ANN DUNCAN
Service Order Number: 2021095004

Greetings:

Farmers Electric Cooperative, Inc. is requesting permission to construct electrical power distribution facilities which will cross County Road 3223 which is located 1700 ft. north of CR 3224 in Hunt County, Texas.

Site location map and construction sketches are enclosed. The construction sketch details the proposed work. All road crossings will have a minimum vertical clearance of 22 feet.

If you have any questions, please contact me at any time.

Sincerely,

Cody Bland

Project Coordinator
cbland@farmerselectric.coop
Phone 903-456-1722

Submitted by Brandon Darrow
bdarrow@farmerselectric.coop
Field Engineering Coordinator

Enclosures

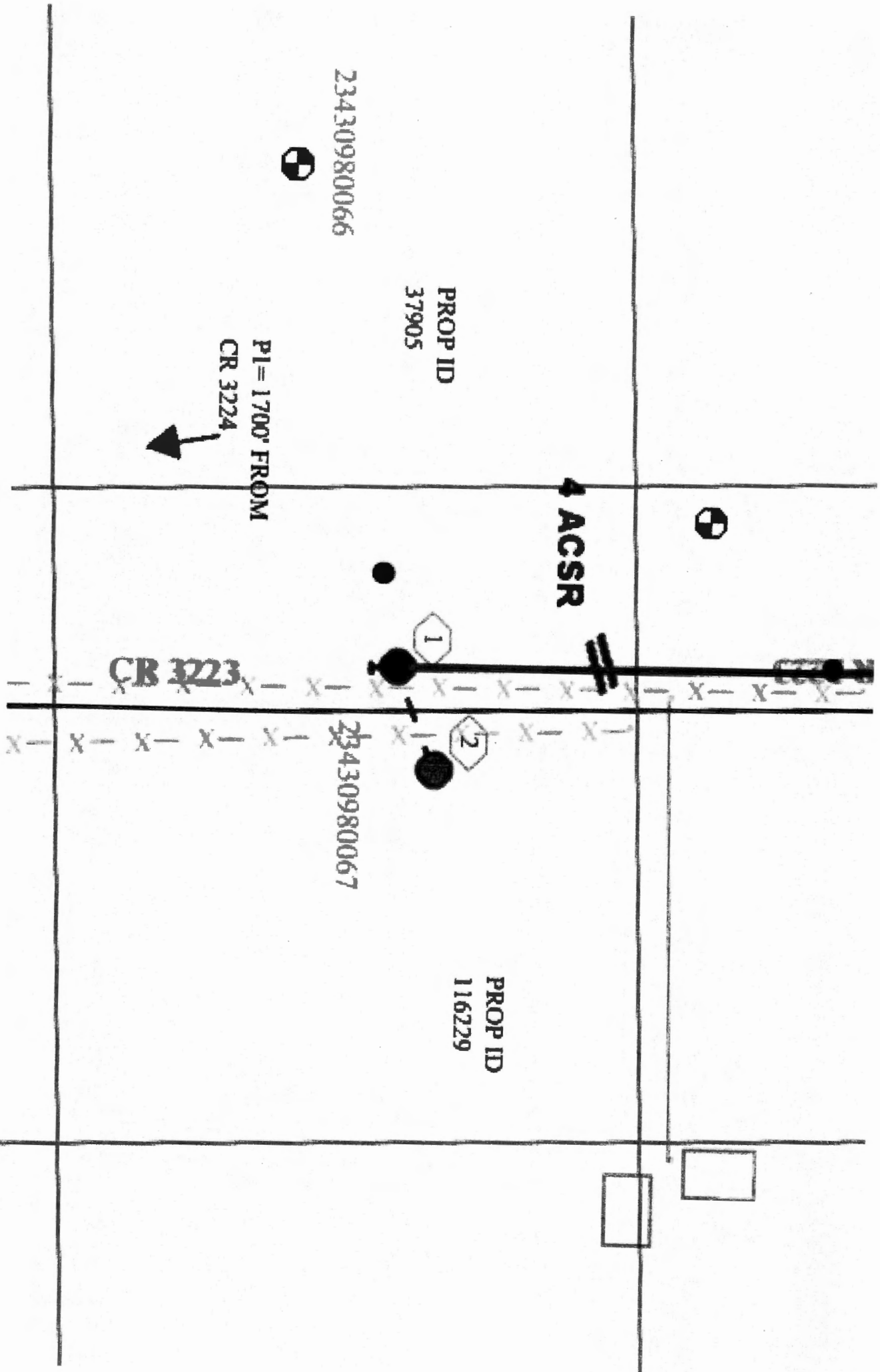

PROP ID
37905

23430980066

P1 = 1700' FROM
CR 3224

AC SR

CB 3223

1

2

23430980067

PROP ID
116229

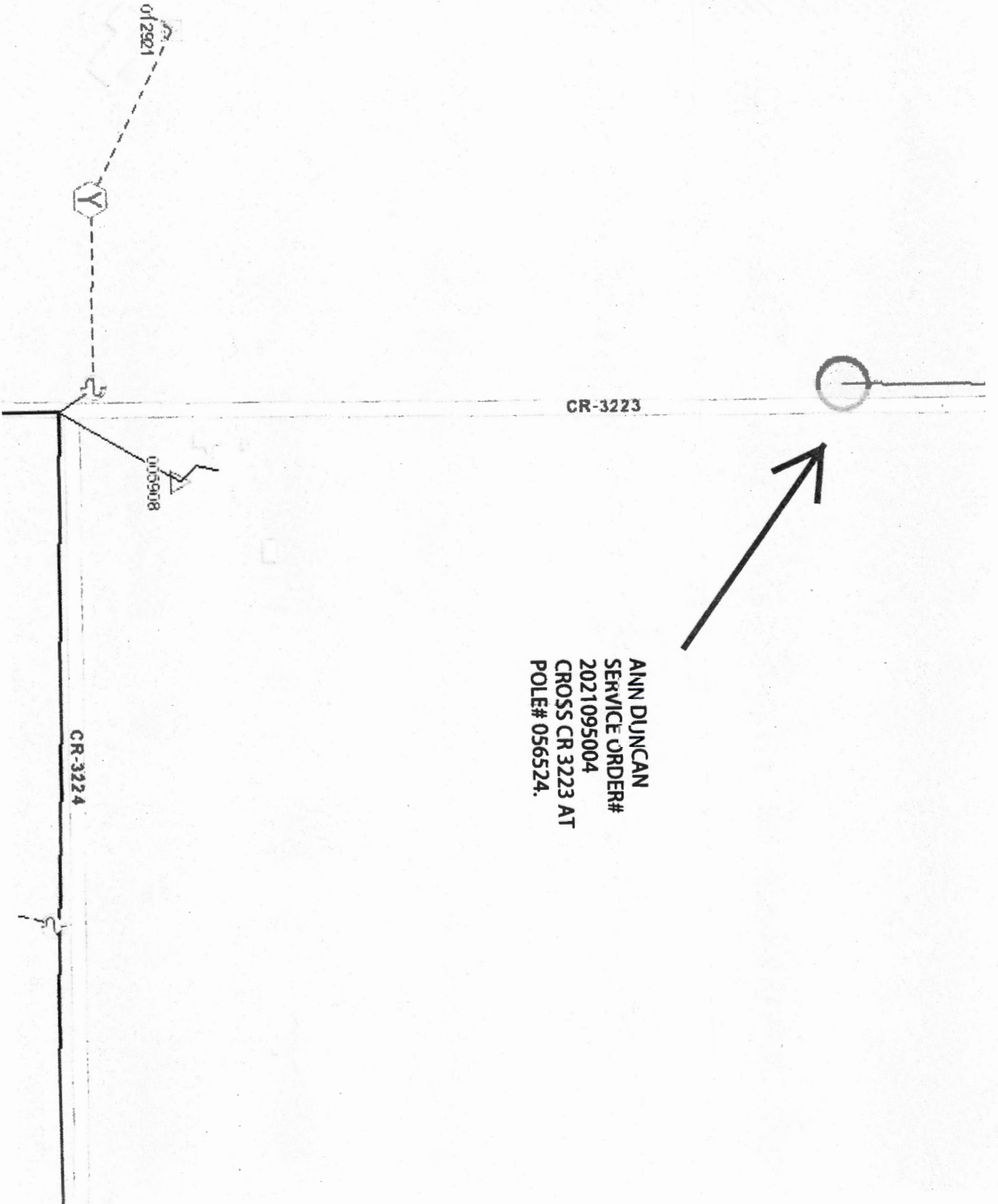

ANN DUNCAN
SERVICE ORDER#
2021095004
CROSS CR 3223 AT
POLE# 056524.